

POP UP CLOSET FLANGE



Material Specifications

- Designed to secure toilet to waste piping connection and floor

Design Features

- Fits both 3" and 4" schedule 40 piping
- Test Version holds up to 5 floors of pressure
- Patented easy no hassle pop up test cap feature
- Patented 304 Stainless Steel inserts give the strength of a steel ring with the corrosion resistance of polymers
- One of the strongest polymer flanges on the market
- 14 hole options for securing to the floor allow for versatile installation
- Centering lines allow for easy alignment during installation

Compliance/Listings

- ABS Listed through IAPMO to ASTM D2661, File number 2602
- PVC Listed through IAPMO to ASTM D2665, File number 2737
- Compliant to Uniform Plumbing Code (UPC®)
- Compliant to International Plumbing Code (IPC®)



PART NUMBER	DESCRIPTION	CARTON QTY
P-3301	3x4, PVC with Test Cap	24
P-3302	3x4, ABS with Test Cap	24
P-3303	3x4, PVC without Test Cap	24
P-3304	3x4, ABS without Test Cap	24
P-3311	3x4, PVC w/SS inserts & Test Cap	24
P-3312	3x4, ABS w/SS inserts & Test Cap	24
P-3313	3x4, PVC w/SS inserts & w/out Test Cap	24
P-3314	3x4, ABS w/SS inserts & w/out Test Cap	24

Installation

1. Secure closet flange over drain pipe and connect per piping manufacturer's instructions.

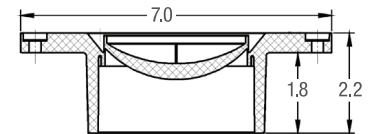

2. Secure to floor with appropriate number and size of screws.
3. Test plumbing system.

4. After test, position screw driver as shown here. Pop up test cap. If necessary, use screw driver at second location and use channel locks for a final removal of test cap.

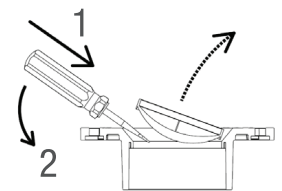

5. Install toilet per manufacturer's instructions.

Product Submittal	
Job Name:	Date:
Part Number:	Quantity:
Architect:	
Contractor:	

Content matter is subject to change at any time. It is the user's responsibility to ensure the most updated revisions are obtained. RF/S-2001 (03-02) Rev 1