



**Z187**

SPECIFICATION SHEET

**6 X 7 [152 X 178] OR 8 X 12 [203 X 305]  
OBLIQUE SCUPPER DRAIN**

TAG \_\_\_\_\_

Dimensional Data (inches and [ mm ]) are Subject to Manufacturing Tolerances and Change Without Notice

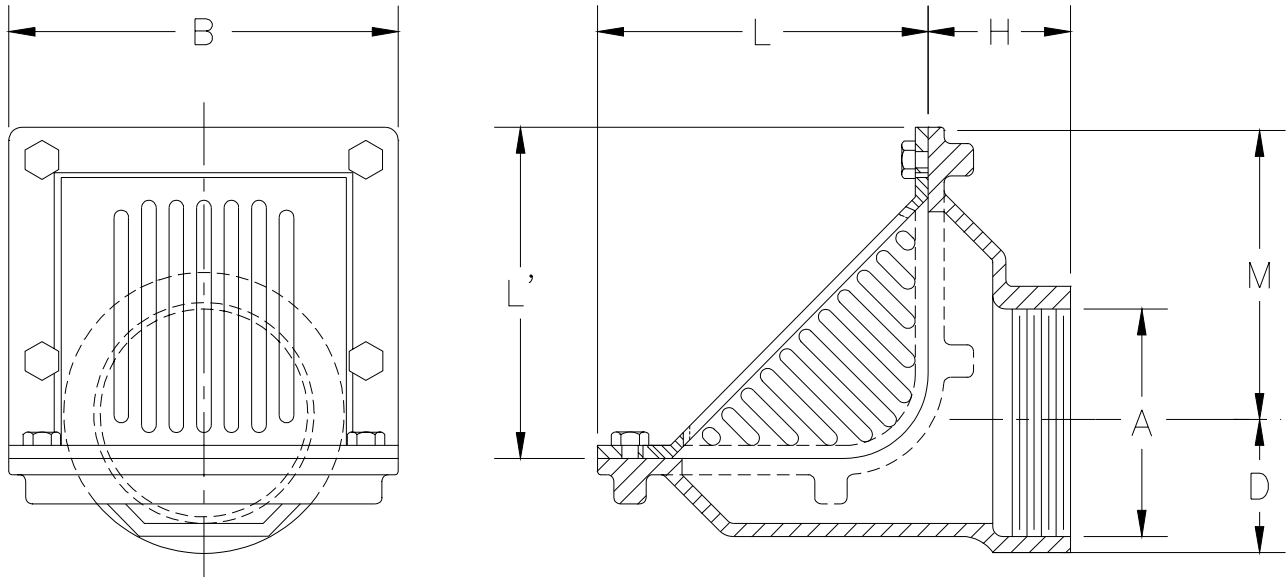

| A-Pipe Size Inches | Dimensions In Inches [mm] |             |            |             |             |             | Approx. Wt. Lbs. [kg] | Grate Open Area Sq. In. [cm <sup>2</sup> ] |
|--------------------|---------------------------|-------------|------------|-------------|-------------|-------------|-----------------------|--|
|                    | B                         | D           | H          | L           | L'          | M           |                       |  |
| 2 [50]             | 7 1/2 [191]               | 1 1/2 [38]  | 2 3/4 [70] | 6 3/8 [162] | 6 3/8 [162] | 6 5/8 [168] | 22 [10]               | 20 [129]                                   |
| 3 [75]             |                           | 2 [51]      |            |             |             | 6 1/8 [156] |                       |  |
| 4 [100]            |                           | 2 1/2 [64]  |            |             |             | 5 5/8 [143] |                       |  |
| 6 [150]            | 12 1/2 [318]              | 3 1/2 [89]  | 3 1/2 [89] | 8 3/8 [213] | 8 3/8 [213] | 7 7/8 [200] | 32 [15]               | 57 [368]                                   |
| 8 [200]            | 12 1/2 [318]              | 4 5/8 [117] | 3 1/2 [89] | 8 3/8 [213] | 8 3/8 [213] | 7 3/8 [187] | 33 [15]               | 57 [368]                                   |

**ENGINEERING SPECIFICATION:** ZURN Z187 6 x 7 [152 x 178] or 8 x 12 [203 x 305] Scupper drain, Dura-Coated cast iron body with reversible back or bottom outlet, oblique aluminum grate with 90° combination frame and membrane flashing clamp.

**OPTIONS** (Check/specify appropriate options)

**PIPE SIZE**

2 thru 4, 6, 8 [50 thru 100, 150, 200]  
(IP w/Z1040)

(Specify size/type) **OUTLET**

\_\_\_\_ IP Threaded  
\_\_\_\_ NH No-Hub

**BODY HT. DIM.**

See Chart  
See Chart

**PREFIXES**

- \_\_\_\_ Z D.C.C.I. Body with Grate\*
- \_\_\_\_ ZB D.C.C.I. Body with Polished Bronze Grate
- \_\_\_\_ ZN D.C.C.I. Body with Polished Nickel Bronze Grate
- \_\_\_\_ ZRB D.C.C.I. Body with Plain Bronze Grate

**SUFFIXES**

- \_\_\_\_ -BS Bronze Mesh Screen Over Grate
- \_\_\_\_ -DA Downspout Adapter (Previously Z188)  
(2 [50] thru 4 [100], 6 [150] only)
- \_\_\_\_ -FG Flush Grate
- \_\_\_\_ -G Galvanized Cast Iron
- \_\_\_\_ -TS Secured Top
- \_\_\_\_ -VP Vandal Proof Secured Top

|                |                  |                |
|----------------|------------------|----------------|
| REV. E         | DATE: 10/16/03   | C.N. NO. 91437 |
| DWG. NO. 59231 | PRODUCT NO. Z187 |                |

\*REGULARLY FURNISHED UNLESS OTHERWISE SPECIFIED