

TALON CLAMP



Part Number	Description	Parts/Bag	MSTR CTN QTY/LBS
P-40429	3/8" CTS	100	1000
P-40433	1/2" CTS	100	1000
P-40434	3/4" CTS	100	1000
P-40435	1" CTS	50	500
P-40436	1-1/4" CTS	25	250

SPECIFICATION

Furnish and install Talon Clamp as manufactured by LSP.

DESIGN FEATURES

- Constructed of high-impact plastic
- Fast and easy to use
- Pre-installed barbed nail prevents backout
- Black in color

COMPLIANCES/LISTINGS

- IAPMO File # 5822



DIMENSIONS

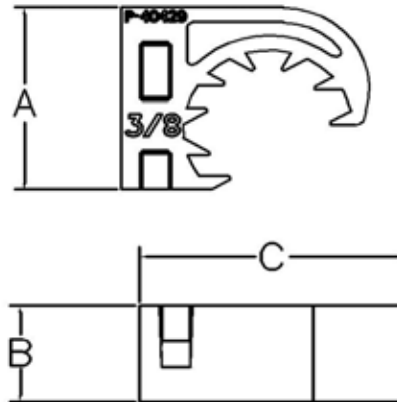

Part Number	A	B	C
P-40429	3/4"	3/8"	7/8"
P-40433	1"	3/8"	1"
P-40434	1-1/4"	3/8"	1-1/2"
P-40435	1-1/2"	1/2"	1-3/4"
P-40436	1-3/4"	1/2"	2-1/8"

Product Submittal	
Job Name:	Date:
Part Number:	Quantity:
Architect:	
Contractor:	

Content matter is subject to change at any time. It is the user's responsibility to ensure the most updated revisions are obtained. Rev 3 2/2021