

SPECIFICATION:

JOSAM 17380-M1644 SERIES FLOOR-MOUNTED, SINGLE LAVATORY CARRIER WITH EXPOSED ACID-RESISTING WHITE COATED ARMS, LEVELING AND SECURING SCREWS, STRUCTURAL UPRIGHTS, WELDED FEET AND CHROME PLATED TRIM.

**LAVATORY CARRIER
FLOOR-MOUNT EXPOSED ARM**

SERIES **17380-M1644**

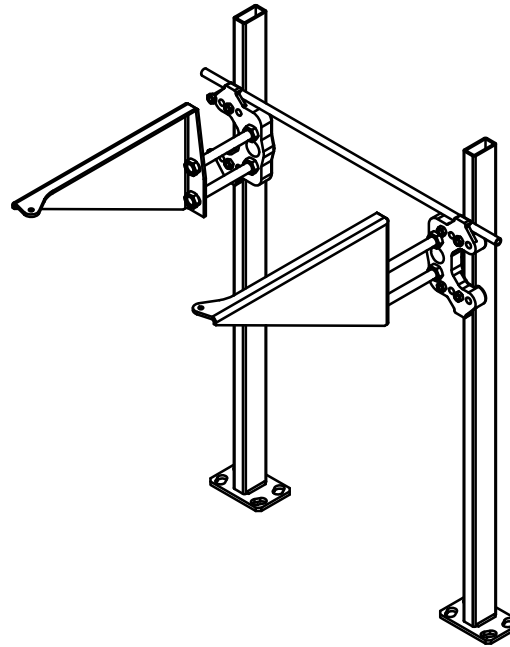
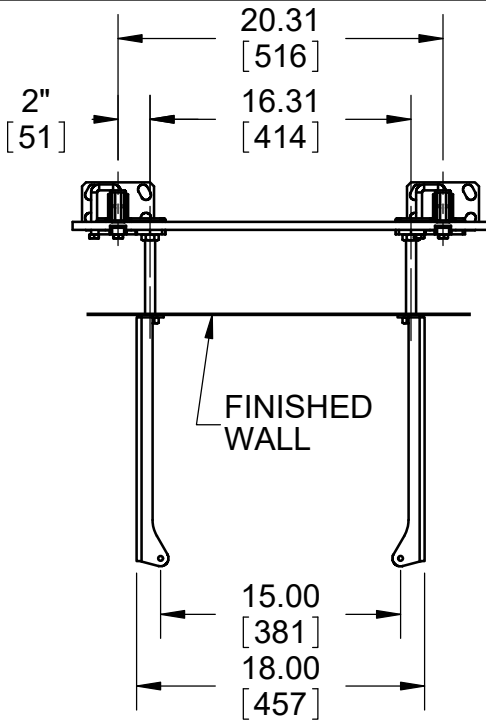

MANUFACTURER
SLOAN

NUMBER
SS-3000

SIZE
17\"/>

NAME
WALL HUNG LAV SINK

A _____
 RIM HEIGHT 'A' BASED ON 'A' DIM SHOWN

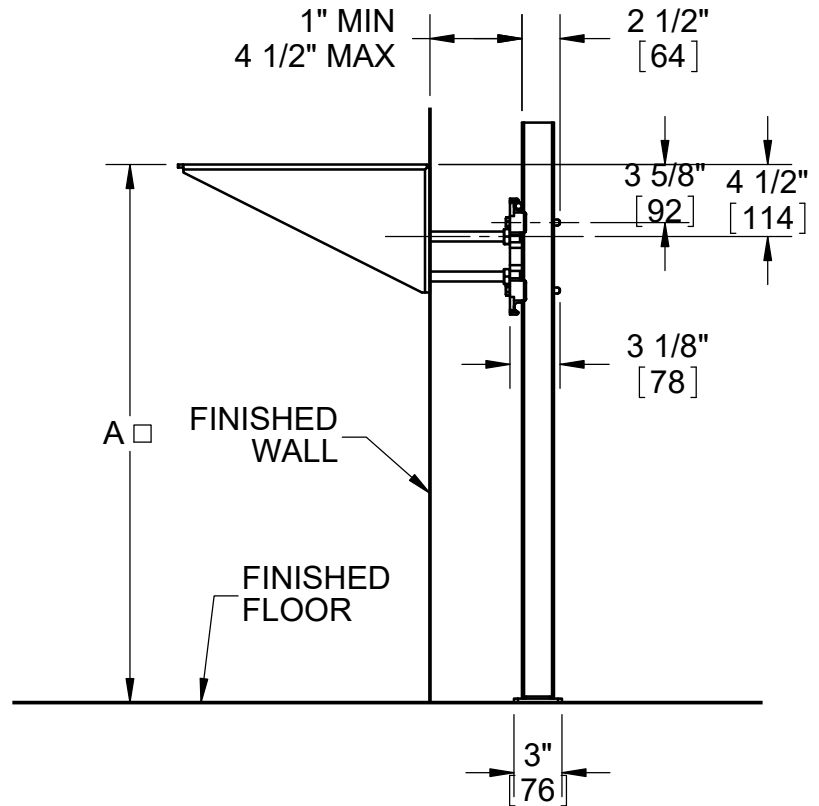
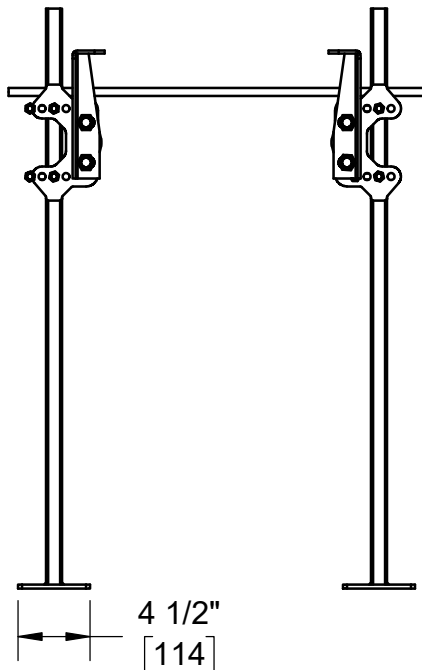

RECOMMEND ALL FEET BE SECURED TO FLOOR WITH 1/2" BOLTS AND ANCHORS BY OTHERS.

□ VARIABLE - DEPENDS ON FIXTURE

-BB	BACK-TO-BACK CARRIER
-HD	HEAVY DUTY
-VP	VANDAL-PROOF TRIM

-10	STUDS FOR WALLS OVER 4-1/2" (SPEC. WALL THICKNESS)
-60	VALVE PLATE FOR ATTACHED TO UPRIGHT
-66	SPLIT HEADER FOR STAINLESS STEEL ARMS

WARNING: Cancer and Reproductive Harm - www.P65Warnings.ca.gov

DATE OF LAST CHANGE: 06/05/18

DIMENSIONS ARE SUBJECT TO MANUFACTURERS TOLERANCES AND CHANGE WITHOUT NOTICE. WE CAN ASSUME NO RESPONSIBILITY FOR USE OF SUPERSEDED OR VOID DATA.



MICHIGAN CITY, INDIANA

NOTES