

8590 Cleanout Plug

Project	Engineer	Mechanical
---------	----------	------------

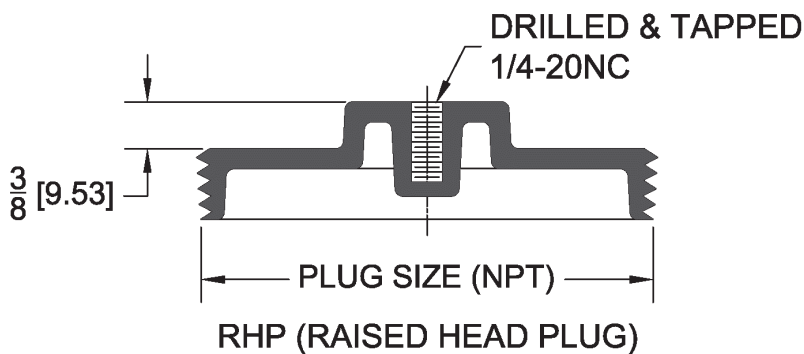
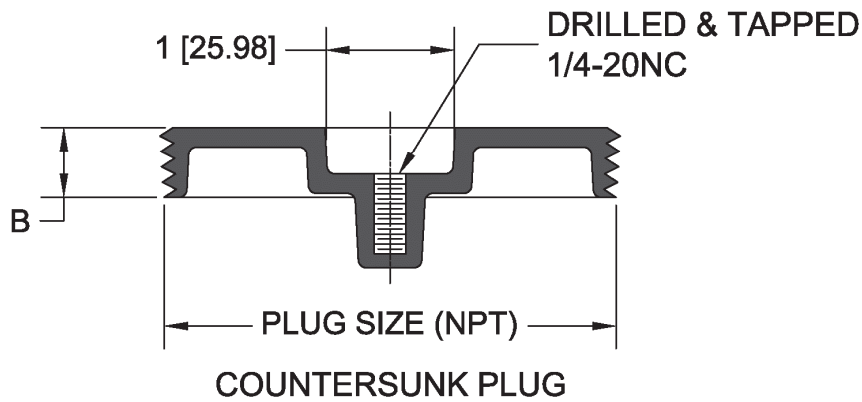
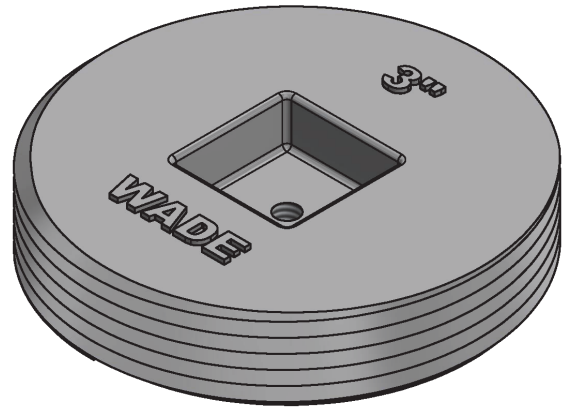
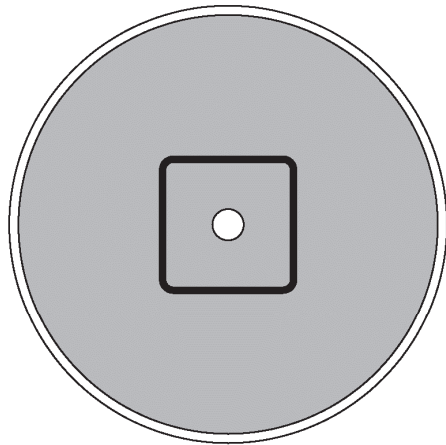

Plug Size	B	•	
		(-75) Brass	ABS Plastic
1-1/2"	7/16"		
2"	7/16"		
2-1/2"	5/8"		
3"	3/4"		
3-1/2"	3/4"		
4"	13/16"		
5"	15/16"		
6"	1"		
8"	1"		

**Regularly Furnished:** ABS plastic countersunk plug, tapped for screw.

Suffix Options		
Suffix	Description	•
-RHP	Raised Head Plug (Brass Only)	
-266	Plug Wrench	