



TRADITIONAL DRINKING FOUNTAINS

INSTALLATION/MAINTENANCE INSTRUCTIONS

INSTALLATION INSTRUCTIONS FOR FOUNTAIN M-34

Prepare trench for water-supply line and waste line (if required). Below fountain location, prepare hole to trench depth and large enough for a person to work. Lay water-supply line and waste line (if required) into trench. Run supply line to above grade level, allowing extra line length to be trimmed during hookup.

Install drinking fountain fully assembled as shipped. Position drinking fountain at desired location. Brace fountain by laying two boards across hole and under foundation base, one on either side of black pipe. To ensure plumb installation, lay a bubble level on fountain bowl and adjust bracing until unit is level.

Purge supply line. Connect water supply line trimming length as necessary. Depending on code and design requirements, drain may be open, French or sanitary connection. Make certain that drain line is plumb. For open drain, wrap bottom opening with fabric filter and place a minimum of three cubic feet (0.085 cubic meters) of large, round rock under drain opening. Local soil conditions may require more rock for drainage.

Insert anchors (by others) through pedestal base, tapered end orientated upwards. Fasten nuts (by others) on anchors allowing approximately 3/8" (0.95 cm) of thread above nuts. Back-fill trench and hole leaving sufficient depth in hole to accommodate concrete slab. Compact back-filled earth. Remove bracing boards.

Pour concrete to grade level, encasing anchor bolts. Finish concrete as necessary, ensuring that top surface of slab is flat and level. After concrete has cured, remove support boards and allow fountain to rest on concrete.

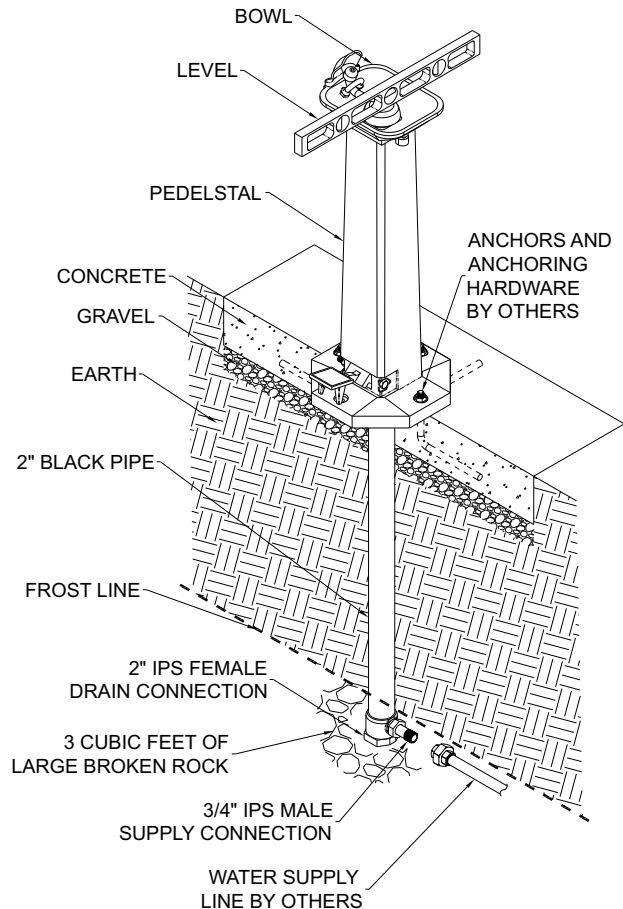

MAINTENANCE INSTRUCTIONS

Remove bolts from underneath drinking fountain bowl. Remove nut and bolt securing pedal to pedestal. Carefully lift bowl straight up, removing bowl and line assembly.

Unscrew packing ring from valve body at the bottom of assembly and remove seat washer screw. Remove and replace seat washer, cup washer and ring washer. Replace seat washer screw and packing ring.

Carefully lower bowl and line assembly into pedestal base. As bowl approaches top of pedestal lower gently until valve body encounters valve stem below grade. Carefully work bowl and line assembly until valve body slips around valve stem, allowing bowl to drop freely to the top of pedestal.

With pedal facing front, ensure mouthguard is orientated to the left. Secure bowl to pedestal with bolts. Replace foot pedal into pedestal and work bolt through pedestal and pedal. Secure with nut.

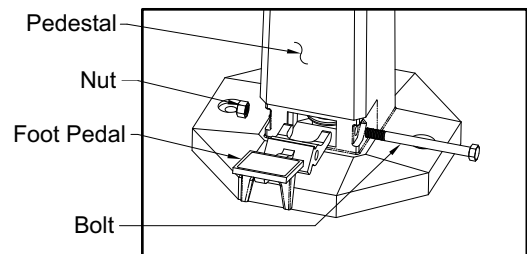
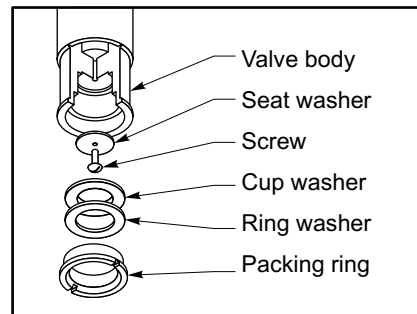

Please visit www.murdock-supersecur.com for most current specifications.

