



# Z-100-90

# SPECIFICATION SHEET

## 15 [381] DIAMETER LATERAL ROOF DRAIN

TAG \_\_\_\_\_

Dimensional Data (inches and [mm]) are Subject to Manufacturing Tolerances and Change Without Notice

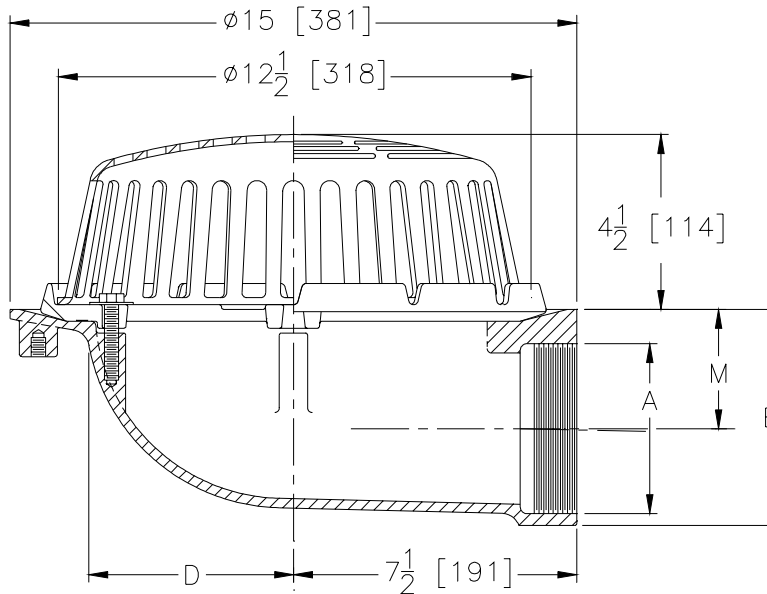

Dimensions In Inches			Approx. Wt. Lbs. [kg]	Dome Open Area Sq. In [sq. cm]
A Pipe Size	D	M		
2 [50]	5 1/2 [140]	4 1/4 [108]	37 [17]	103 [665]
3 [75]		3 11/16 [94]	35 [16]	
4 [100]		3 3/16 [81]	36 [16]	
5 [125]	5 7/8 [149]	4 13/16 [122]	45 [20]	
6 [150]		4 1/4 [108]	45 [20]	

### SUFFIXES

- \_\_\_ -AC Angular Underdeck Clamp
- \_\_\_ -AR Acid Resistant Epoxy Coated
- \_\_\_ -AW 3/4 [19] to 4 [102] Adjustable Water Level Regulator (Specify Height) (ZC only)
- \_\_\_ -BS Bronze Mesh Screen Over Dome
- \_\_\_ -C Underdeck Clamp
- \_\_\_ -E Static Extension 1 [25] thru 4 [102] (Specify Ht.)
- \_\_\_ -EA Adjustable Extension Assembly 1 3/4 [44] thru 3 1/2 [89]
- \_\_\_ -ES Static Extension with Secondary Clamp Collar at Body
- \_\_\_ -FG Flush Grate (Replaces Dome Strainer)
- \_\_\_ -G Galvanized Cast Iron
- \_\_\_ -GD Galvanized Cast Iron Dome (ZC only)
- \_\_\_ -R Roof Sump Receiver
- \_\_\_ -SC Secondary Clamping Collar
- \_\_\_ -SS Stainless Mesh Screen Over Dome
- \_\_\_ -VP Vandal Proof Secured Top
- \_\_\_ -W2 2" [51] Internal Water Dam
- \_\_\_ -W3 3" [76] Internal Water Dam
- \_\_\_ -W4 4" [102] Internal Water Dam
- \_\_\_ -XJ Vertical Expansion Joint (See Z-190)
- \_\_\_ -84 Stainless Steel Perforated Gravel Guard
- \_\_\_ -85 Stainless Steel Perforated Extension
- \_\_\_ -89 2 [51] High External Water Dam

### OPTIONS (Check/specify appropriate options)

**ENGINEERING SPECIFICATION: ZURN Z-100-90**  
 15 [381] Diameter lateral roof drain. Dura-Coated cast iron body with combination membrane flashing clamp/gravel guard, and low silhouette Poly-Dome strainer.

### PREFIXES

- \_\_\_ Z- D.C.C.I. Body with Poly-Dome\*
- \_\_\_ ZA- D.C.C.I. Body with 6 3/4 [171] High Aluminum Dome
- \_\_\_ ZC- D.C.C.I. Body with Cast Iron Dome
- \_\_\_ ZRB- D.C.C.I. Body with Plain Bronze Dome

### PIPE SIZE

2, 3, 4 [50 thru 100]  
 5, 6 [125, 150]

### (Specify size/type) OUTLET

- \_\_\_ IP Threaded
- \_\_\_ IP Threaded

### E BODY HT. DIM.

5 3/4 [146]  
 7 7/8 [200]

REV. B	DATE: 11/11/99	C.N. NO. 83962
DWG. NO. 35053		PRODUCT NO. Z-100-90

\*REGULARLY FURNISHED UNLESS OTHERWISE SPECIFIED