

P1100-DA Plastic Floor Drain Body with Double Adjustable Round Top Assembly

ASME Load Rating	
(-1) Nickel Bronze	(-85) Stainless Steel
Light Duty	Medium Duty

Project	
Engineer	
Mechanical	

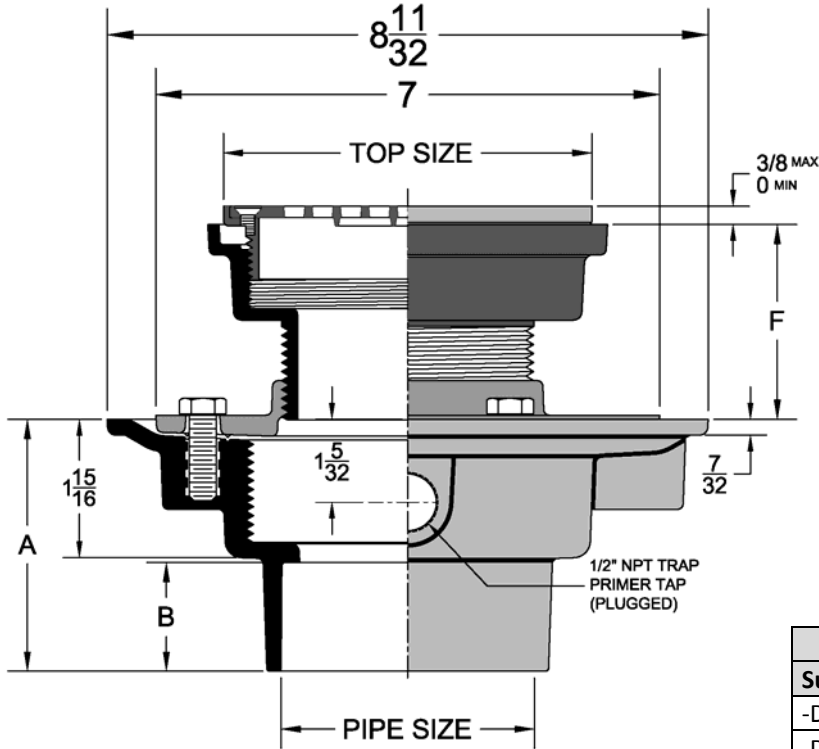

1100-DA5-1-3PVC

*Dimensions vary from illustration

Top Size	F	
	Min	Max
5	1 7/8	2 3/4
6	1 7/8	2 3/4

Dimensions (Inches)		
Outlet Size	A	B
2"	3-1/32	1
3"	3-1/2	1-1/2
4"	3-3/4	1-3/4

Top Size & Type			Grate Free Area (Sq. In.)
	-1 Cast Iron Body with Satin Finish Nickel Bronze Top	-85 Cast Iron Body with Satin Finish Stainless Steel Top	
DA5			8.8
DA6			11.0

Regularly Furnished: ABS or PVC plastic drain body with flange, integral clamping collar, seepage openings, 1/2" primer tap with plug & adjustable type "A" top assembly.

Outlet Variations		
Type	Designation	
ABS	2ABS,3ABS,4ABS	
Push On Gasket	2PVC,3PVC,4PVC	

Suffix Options		
Suffix	Description	
-DC	Debris Cover	
-DIA	Deck Installation Assembly*	
-EF4	4" Round Funnel Assembly *	-1
		-2
		-85
-EF6	6" Round Funnel Assembly *	-1
		-2
		-85
-EG6	6" Elongated Funnel Assembly*	-1
		-2
		-85
-EG8	8" Elongated Funnel Assembly*	-1
		-2
		-85
-TSD	Trap Seal Device (See Model 4405)	
-VP	Vandal Proof Top Assembly	
-X	Heavy Duty Top Assembly (A6 Only)	
-23	Grate Riser (Extends Grate 3/8")	
-27	Sediment Bucket	
-31	Backwater Valve	
-33	Closure Plug	
-39	Galvanized Cast Iron	
-83	Special Engraving	
-94	Cast Iron Extension Adapter*	Painted
		-39
-102	Chrome Plated Top Assembly	