

Steel Rivets

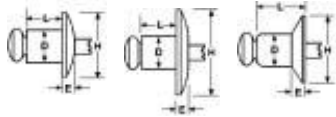

Plated-Steel Rivet • Coated Steel Mandrel • IFI Grade 30

Buttonhead AFS Part No.	D Rivet Dia. Nom. Inch (mm)	Drill No. & Hole Size (mm)	H Head Dia. Nom. Inch (mm)	E Head Height Max. Inch (mm)	L Rivet Length Max.		Grip Range		Typical Ultimate Strength (Lbs.) (newtons)	
					Inch	(mm)	Inch	(mm)	Shear	Tensile
SB3-2	3/32*(.094)	#41(.097-.100)	.188	.032	.250	6.4	.032-.125	0.8-3.2	160	200
SB3-4	2.4	2.5(2.46-2.54)	4.78	0.81	.375	9.5	.126-.250	3.3-6.4	711	889
SB4-1	1/8*(.125)	#30(.129-.133)	.250	.040	.212	5.4	.032-.062	0.8-1.6	305	410
SB4-2	3.2	3.3(3.28-3.38)	6.35	1.02	.275	7.0	.063-.125	1.7-3.2	1356	1823
SB4-3					.337	8.6	.126-.187	3.3-4.8		
SB4-4					.400	10.2	.188-.250	4.9-6.4		
SB4-5					.462	11.7	.251-.312	6.5-7.9		
SB4-6					.525	13.4	.313-.375	8.0-9.5		
SB4-8					.650	16.5	.376-.500	9.6-12.7		
SB4-10					.775	19.7	.501-.625	12.8-15.9		
SB5-2	5/32*(.156)	#20(.160-.164)	.312	.050	.300	7.6	.062-.125	1.6-3.2	420	600
SB5-3	4.0	4.1(4.06-4.16)	7.92	1.27	.362	9.2	.126-.187	3.3-4.8	1868	2668
SB5-4					.425	10.8	.188-.250	4.9-6.4		
SB5-6					.550	14.0	.251-.375	6.5-9.5		
SB5-8					.675	17.2	.376-.500	9.6-12.7		
SB5-10					.800	20.3	.501-.675	12.7-17.1		
SB5-12					.925	23.5	.676-.750	17.2-19.1		
SB6-2	3/16*(.187)	#11(.192-.196)	.375	.060	.325	8.3	.062-.125	1.6-3.2	610	870
SB6-4	4.8	4.9(4.88-4.98)	9.53	1.52	.450	11.5	.126-.250	3.3-6.4	2713	3869
SB6-6					.575	14.6	.251-.375	6.5-9.5		
SB6-8					.700	17.8	.376-.500	9.6-12.7		
SB6-10					.825	21.0	.501-.625	12.8-15.9		
SB6-12					.950	24.2	.626-.750	16.0-19.1		
SB6-14					1.075	27.3	.751-.875	19.1-22.2		
SB6-16					1.200	30.5	.876-1.000	22.3-25.4		
SB8-2	1/4*(.250)	F(.257-.261)	.500	.080	.370	9.4	.062-.125	1.6-3.2	1270	1550
SB8-4	6.4	6.5(6.53-6.63)	12.70	2.03	.500	12.7	.062-.250	1.6-6.4	5649	6894
SB8-6					.625	15.9	.251-.375	6.5-9.5		
SB8-8					.750	19.1	.376-.500	9.6-12.7		
SB8-10					.875	21.0	.501-.625	12.8-15.9		
SB8-12					1.000	25.4	.626-.750	16.0-19.1		
SB8-14					1.125	28.6	.751-.875	19.1-22.2		
SB8-16					1.250	31.8	.876-1.000	22.3-25.4		

KLIK-FAST RIVETS conform to IFI-114 (inch) and IFI-505 (metric). Millimeters (mm) and newtons (N) are in green.